

ProSun SunShower 15 Minute User Manual

4



ProSun[®]
International

ProSun International, LLC
2442 23rd Street North, St. Petersburg Florida
800-874-2776 Ph. 727-825-0400 Fax 727-825-0700
E-mail sales@prosun.com

Member of
NKBA
The Finest Professionals
in the Kitchen
& Bath Industry
National Kitchen & Bath AssociationSM



Table of contents

Table of contents / Serial number.....	2
Warning / Exposure stickers.....	3
General Discription.....	4
Introduction.....	5
Important safety instructions.....	6
Important information on tanning conditions.....	7/8
How long and how often.....	9
ProSun Sunshower use.....	10
Cleaning and Maintenance.....	11
Replacing the lamps / Guarantee/service.....	12
Trouble shooting.....	13
Warranty.....	14



Serial number



⚠️ WARNING

- Follow instructions.
- When using this product, keep a minimum distance with your body of 16 inches or 40 centimeters.
- Avoid overexposure. As with natural sunlight, overexposure can cause eye and skin injury and allergic reactions.
- Repeated exposure may cause premature aging of the skin and skin cancer.
- Protective eyewear is provided with this product and should be worn by all persons in the shower when lamps are on.
- Failure to use protective eyewear may result in severe burns or long-term injury to the eyes.
- Medications or cosmetics may increase your sensitivity to the ultraviolet radiation. Consult a physician before using sunlamp or tanning equipment if you are using medication or have a history of skin problems or believe yourself to be especially sensitive to sunlight.
- If you do not tan in the sun, you are unlikely to tan from the use of this product.
- To reach maximum session times, follow the recommended exposure schedule.
- Not to be used under the age of 16.

ProSun[®]
SUNSHOWER



For maintenance, call your local retailer or contact ProSun at 1-800-874-2776 or www.prosunsunshower.com

Patented

RECOMMENDED TANNING SCHEDULE	SKIN TYPE	MAXIMUM EXPOSURE TIME IN MINUTES Week 1 Week 2 Week 3 Maximum	CERTIFIED LAMPS SUNSHOWER/06	
			The following lamps (or compatible) have been certified for use with this equipment:	
I	Sensitive Skin Burns easily & severely Does not tan	Tanning Not Advised	BODY LAMP: LightTech 300-500HP MA4035HR Philips HPA 400/30S Philips Cleo 250-500/SDFXL This product is in conformity with performance standards for sun lamp products under 21 CFR PART 1040.20	
II	Light Skin Burns easily & severely Tans minimally	2 4 8 15		
III	Normal Skin Burns moderately Tans moderately	3 6 12 15		
IV	Dark Skin Burns minimally Tans well / above average	5 9 13 15		

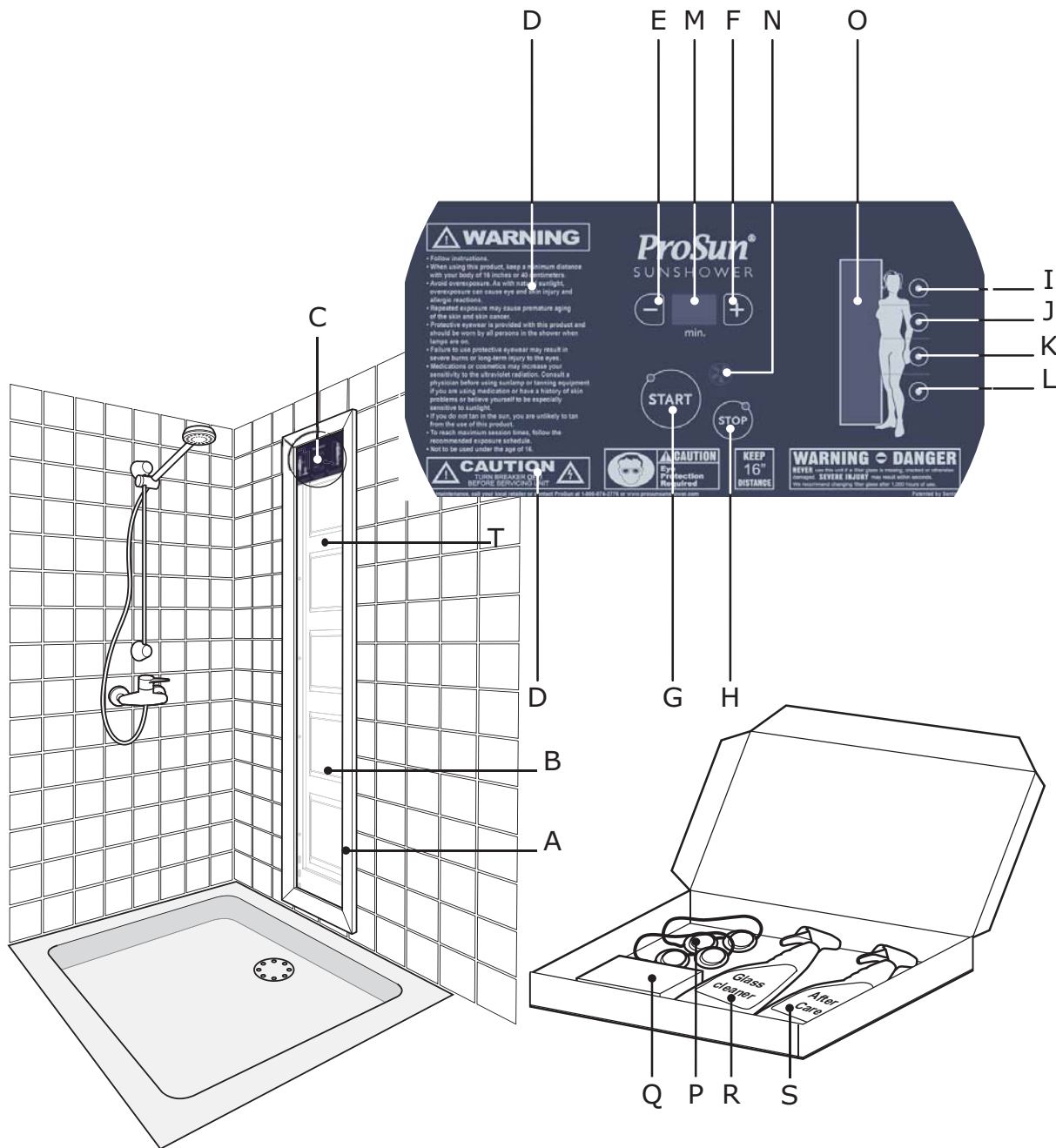

Introduction

CONGRATULATIONS!

Congratulations with the purchase of your ProSun Sunshower. Experience the ultimate holiday feeling of sun and water in your own bathroom! Each of the five powerful UV high-pressure lamps, which are built into the wall, can be used separately. This ensures that each part of your body has the right amount of tanning while you enjoy a relaxing shower. The average shower time (of ten minutes a day) is enough to produce a healthy tan. You can feel your skin absorbing the energy as you shower. With a minimum of effort, you will look great every day!

Relax, enjoy and experience the Sunshower feeling!

The ProSun Sunshower is a ETL approved safe system, if it is installed and used properly according to the instructions. Please, read this user manual carefully.

Tanning and your health

Just as with normal sunlight, the tanning process with the ProSun Sunshower takes time. The first results are only visible after a few sessions. Excessive exposure to ultraviolet light, whether produced by the sun or by a tanning system, can cause sunburns. Besides many other factors like excessive exposure to natural sunlight, incorrect and excessive use of a tanning system can increase the risk of skin and eye complaints. The degree to which these effects occur are on the one hand determined by the nature, intensity and the duration of the exposure and on the other hand by the sensitivity of the person in question. Read warning label.

The more often that the skin and eyes are exposed to UV-light, the greater the risk of inflammation of the cornea and the conjunctiva, damage to the retina, cataracts, premature ageing of the skin and the development of skin cancer. Certain medicines and cosmetics increase the sensitivity of the skin.

General description (page 4)

- | | |
|-------------------------------------|---|
| A. Decorative frame | J. On/off switch for 2 nd uppermost lamp |
| B. Coated glass plate | K. On/off switch for middle lamp |
| C. Operating panel | L. On/off switch for lowest 2 lamps |
| D. Warnings | M. Time display |
| - Warning texts | N. Cool down display |
| - Warning images | O. Display indicating switched-on tanning lamps |
| E. Minus timer button | P. Protective glasses (2 pairs) |
| F. Plus timer button | Q. Sunshower cleaning pad |
| G. Start button | R. Sunshower Glass Cleaner |
| H. Stop button | S. Sunshower After Care |
| I. On/off switch for uppermost lamp | T. Exposure schedule |

Important safety instructions

Installation

- Each ProSun Sunshower must be connected to a dedicated 220 volt circuit that is protected with a 15A GFCI (ground fault circuit interrupter)
- Using the shower before the ProSun Sunshower has been installed is prohibited.
- Ensure that the air inlet and outlet ventilator grills are free of obstacles. The system is fitted with an automatic safety against overheating. The system automatically turns itself off if cooling is insufficient (e.g. because the ventilation openings have been covered). You can turn the system on again as soon as the cause of the overheating has been removed and the system has cooled down sufficiently.

Use

- Carefully read the ProSun Sunshower user manual before use. Please ensure all users have read the safety instructions.
- Keep these instructions. This manual contains important safety instructions and user instructions for the ProSun Sunshower. Always keep this leaflet, which details the general tanning conditions, at hand. These conditions must be accessible to all users.
- Carefully read the text on the operating panel and Exposure schedule (**T**).
- Never use the ProSun Sunshower if the glass plate is damaged and there is a risk of leakage in the Sunshower.

Cleaning

- Maintenance of operating panel (**C**), filter glass (**B**) and frame (**A**): the front of the ProSun Sunshower may only be cleaned manually using the ProSun Sunshower products supplied. Finish with a dry cloth.
- Never use a high-pressure spray to clean the Sunshower.
- Do not clean the ProSun Sunshower when it is turned on.

Maintenance

- The ProSun Sunshower is an electrical system; incorrect use can result in an electrical shock that may cause personal injury and/or damage and/or possible death. Do not open, disassemble or modify one or more parts of the ProSun Sunshower. All guarantees and any form of liability lapse if maintenance and/or repairs are not performed by an installation company recognised by ProSun International.

If there is a fault, contact your dealer (details are given on your Warranty / installation form) or go to: www.prosunsunshower.com for more information.

Important information on tanning conditions

What should I do before using the Sunshower?

- Determine your skin type on the basis of your skin colour (see tanning table).

RECOMMENDED TANNING SCHEDULE	SKIN TYPE		MAXIMUM EXPOSURE TIME IN MINUTES				CERTIFIED LAMPS SUNSHOWER/04
			Week 1	Week 2	Week 3	Maximum	
I	Sensitive Skin	Burns easily & severely Does not tan	Tanning Not Advised				<p>The following lamps (or compatible) have been certified for use with this equipment:</p> <p>BODY LAMP: LighTech 300-500HP MA4035HR Philips HPA 400/30S Philips Cleo 250-500/SDFXL</p> <p>This product is in conformity with performance standards for sun lamp products under 21 CFR PART 1040.20</p>
II	Light Skin	Burns easily & severely Tans minimally	2	4	8	15	
III	Normal Skin	Burns moderately Tans moderately	3	6	12	15	
IV	Dark Skin	Burns minimally Tans well / above average	5	9	13	15	

- Do not expose yourself to excessive natural sunlight on the same day.
- Allow an interval of at least 48 hours between the first and second session.
- Remove creams, lipstick and other cosmetics from your skin well before the tanning sessions.
- Do not expect the system to produce a better result than the sun.

For whom is the ProSun Sunshower suitable?

- The Sunshower is intended for use by anyone older than 16, who is not oversensitive to UV radiation. For more information see: "When can you not use the ProSun Sunshower?".

What to do when using the Sunshower?

- UV-radiation can damage eyes and skin. Always wear the protective glasses that are supplied with the ProSun Sunshower when tanning to protect your eyes against excessive doses of visible light, UV-light and infrared light.
- Maintain the prescribed tanning distance of 16 inch for a homogenous tanning field. To get a beautiful even tan, turn your body relative to the Sunshower.
- Prevent other people from looking directly at the ProSun Sunshower during use in connection with the risk of damaging their eyes.
- Do not use any quick-tanning lotions or creams that are intended to speed up the tanning process.
- Do not use any creams or lotions that are intended to protect your skin against sunburn.
- Do not touch the filter glass during or shortly after use. **It may get hot.**

Important information on tanning conditions

What should one do after using the ProSun Sunshower?

- You can apply a moisturising cream if your skin feels taught after a tanning session.
- Dry yourself immediately if you want to continue tanning after showering.

When can you not use the ProSun Sunshower?

- Children under 16 may not use the ProSun Sunshower.
- The ProSun Sunshower is not suitable for medical use.
- Do not use the system if you are ill and/or are taking medicine or using cosmetics or shower products that increase the sensitivity of your skin. Be extra careful if you are oversensitive to UV radiation. Consult your doctor if in doubt.
- This system may not be used by people whose skin burns without tanning when exposed to sunlight, by people who suffer from sunburns, by children or people who suffer from (or have suffered from) skin cancer or who are susceptible to skin cancer.
- Do not let children play with the system in connection with the risk of damaging one's eyes or skin.
- Consult your doctor if persistant lumps or sores appear on the skin, or if there are changes in pigmented moles.
- Colors may fade under the influence of the sun. The same effect may occur when using this appliance.
- Never use the system if the UV-filter glass is damaged or broken or completely missing.
- If the product is defect or damaged, it must only be repaired by a ProSun assined installer to avoid dangerous situations.

If there is a fault, contact your dealer (details are given on your Warranty / instalation form) or go to: www.prosunsunshower.com for more information.

The sun, tanning, how long and how often?

The sun

The sun produces various types of energy: visible light that allows us to see, ultraviolet (UV) light that tans our skin and infrared (IR) light that gives the sun's rays the warmth that we enjoy.

Tanning and your health

Just as with normal sunlight, the tanning process with the ProSun Sunshower takes time. The first results are only visible after a few sessions. Excessive exposure to ultraviolet light, whether produced by the sun or by a tanning system, can cause sunburns. Besides many other factors like excessive exposure to natural sunlight, incorrect and excessive use of a tanning system can increase the risk of skin and eye complaints. The degree to which these effects occur are on the one hand determined by the nature, intensity and the duration of the exposure and on the other hand by the sensitivity of the person in question.

Warning: DANGER-Ultraviolet Radiation. Follow instructions. Avoid overexposure. As with natural sunlight, overexposure can cause eye and skin injury and allergic reactions. Repeated exposure may cause premature aging of the skin and skin cancer. WEAR PROTECTIVE EYEWEAR; FAILURE TO MAY RESULT IN SEVERE BURNS OR LONG-TERM INJURY TO THE EYES. Medications, shower products or cosmetics may increase your sensitivity to the ultraviolet radiation. Consult physician before using sunlamp if you are using medications or have a history of skin problems or believe yourself especially sensitive to sunlight. If you do not tan in the sun, you are unlikely to tan from the use of this product.

How long and how often?

Keep to the prescribed tanning time that depends on your skin type (see the tanning table on page 3). If this is the first time that you have used a tanning system, ensure that there is a break of at least 48 hours between the first and second session. We recommend that you rest your skin after 5 to 10 days of sessions. Your skin will lose a lot of its colour within approximately one month after you finished the tanning sessions. If this is the case, you can start a new course of sessions. If you want to keep your tan, do not stop your tanning sessions after having completed a course of sessions, but continue with one or two sessions per week.

ProSun Sunshower use:

PROSUN SUNSHOWER OPERATION > HOME USE (See operating panel page 1)

How do I start a standard full body session?

- Press the START button (**G**): the operating panel is activated.
- Press the START button (**G**) again: all lamps are switched on for ten minutes.

How do I start a personalised session?

- Press the START button (**G**): the operating panel is activated.
- Change time: select the length of the treatment (maximum 15 min) by pressing the + button (**F**) or the - button (**E**). The time can also be changed during the treatment.
- Lamp choices: the keys (**I,J,K,L**) on the operating panel correspond with the HPA lamps. All five are turned on as standard. If you want to determine which arrangement of HPA lamps come on, turn them on or off by pressing the corresponding lamp keys (**I,J,K,L**). You cannot change your desired arrangement again during your tanning session. The lowest key (**L**) operates the lowest two lamps.
- Press the START button (**G**) again: the selected lamps are switched on during the time set.

What can I change during the tanning session?

- During tanning, you can change the tanning time to a maximum of 15 minutes.
- The ProSun Sunshower will give a signal one minute before the end of the tanning session, so that you can change the tanning time if required.
- You cannot change the selected lamp combination during tanning.

What happens after the ProSun Sunshower is turned off?

- The Sunshower will cool down for three minutes after it has been turned off before it can be used again (cool down symbol (**N**) illuminated).
- If the "cool down" symbol is illuminated (**N**) on the operating panel, the Sunshower is cooling down (three minutes post-cooling time). The ProSun Sunshower cannot be used during the post-cooling period.

How do I stop the ProSun Sunshower before the end of the session?

- The treatment finishes prematurely when you press the STOP button (**H**). Then the Sunshower automatically cools down for three minutes ("cool down" symbol (**N**) illuminated).

Cleaning and maintenance of the ProSun Sunshower

The front of the Sunshower is the only part that can be cleaned by the users: this includes the decorative frame (A), the coated glass (B) and the operating panel (C).

Cleaning advice for the coated glass

The glass plate (B) is treated with a special coating to reduce the risk of scale. Coated glass is a material that is not as prone to scratching as plastic, but it can nevertheless be scratched easily. Consequently, "treating" the glass well, which includes cleaning, is important. Dirt and spots can be best removed by using a small quantity of ProSun Sunshower Glass Cleaner (R) and the ProSun Sunshower Pad provided (Q). Use a rubber wiper to wipe the wet surface dry. Then rub the surface with a slightly moist terry cloth or a squeezed out chamois. The surface then dries evenly. To restore the coating, use ProSun Sunshower After Care (S). Under no circumstances use glass cleaner or "multi-purpose cleaner": as this often creates "dry spots" and/or leaves behind deposits.

How do I order a new cleaning pack?

If you want to order a new cleaning pack, go to www.prosunsunshower.com for more information.

Cleaning advice for the decorative frame

Remove with a moist cloth/sponge, which you also use to clean the windows. Possibly add non-caustic pH neutral cleaning agent dissolved in lukewarm, clean water. Again remove with a moist cloth. Dry with a clean dry cloth. For very dirty spots, use pure cleaning agent. Remove again with a clean, moist cloth and dry with a clean dry cloth.

Replacing the lamps

The UV output of the tanning lamps declines with time (this occurs under normal usage after a number of years). The lifespan of the Philips HPA Cleo Swift 250-500 is 600-800 hours. After 600 burning-hours, the LED displays corresponding to the lamps concerned on the operating panel **(O)** start to flicker after you press the start button **(G)**. By pressing the start button **(G)** again, you can continue using the Sunshower, but you are advised to contact your Sunshower installer (details are stated on your Warranty / installation form. The Sunshower installer will replace the lamps.

Replacing the lamps yourself is prohibited.

Garantee & service

ProSun Sunshower installation

The final assembly of the proSun Sunshower must be performed by an installation company recognised by ProSun International,LLC. The specialist shop where you purchased the ProSun Sunshower will arrange this. The installer will install the ProSun Sunshower. If the ProSun Sunshower is installed safely according to the standards, an approval sticker will be put on the Sunshower. Your Sunshower Warranty / instalation form is only valid in combination with this special ProSun Sunshower approval sticker. The limited warranty term of the Sunshower is 2 years.

ProSun Sunshower Warranty / instalation form.

You will receive the ProSun Sunshower warranty / instalation form from an installer recognised by ProSun International, LLC after the installation of the ProSun Sunshower.

Not under warranty

The following components are not covered:

- The HPA 400 watt lamps;
- 400 watt ignitors;
- The blank glass and the blue glass.

Disclaimer

ProSun International, LLC liability is limited to defects in manufacture or design. ProSun Sunshower cannot be held responsible for the consequences of careless usage of this product or for the consequences of the violation of local regulation.

Trouble shooting

ERROR MESSAGES

If the ProSun Sunshower does not function as it should or needs maintenance, two types of error message may appear on the display (M):

1. **Er + UI:** Temperature / Glass closure error message
2. **LA + flickering lamps:** the burning-hours have been exceeded

1. What do you do if Er + UI appear on the display (M)?

This means that there is a temperature or glass closure error message.

There is a problem. Check whether the air inlet/outlet opening in the other room is not blocked. If this is not the case, contact your ProSun Sunshower installer (details are given on your warranty / installation form). To be on the safe side, do not use the shower or turn the electricity off at the meter box. **Never open the ProSun Sunshower yourself.**

2. What do I do if LA + flickering lamps appear on the display?

This means that there is a message indicating that the burning-hours have been exceeded. The UV lamps are due for replacement. The UV lamps have exceeded the number of burning-hours (according to the manufacturer's instructions) and must be replaced. You can still use the Sunshower by pressing the start button (G) again, but we recommend that you contact your Sunshower installer (details are given on your warranty / installation form). The Sunshower installer will replace the lamps. **Replacing the lamps yourself is prohibited.**

If the operating panel does not respond and the Sunshower does not go on, take the same steps as given by point 1 of 'Solving Problems'.

If there is a fault, contact your dealer (details are given on your warranty / installation form) or go to: www.prosunsunshower.com for more information.

Conclusion

The Sunshower helps you to look healthy with the minimum of effort. Sunshower International wishes you a lot of pleasure and a healthy tan with your new purchase! If you have any tips or complaints, we would greatly appreciate it if you would mail sales@prosun.com.

***PROSUN SUNSHOWER, COLOUR YOUR LIFE!
Tan While You Shower***

ProSun International,LLC. ® LIMITED WARRANTY EFFECTIVE July 1th, 2006

1. Warranty Period: PROSUN warrants new Sunshower tanning equipment manufactured or imported by it, provided it is still owned and operated by the original purchaser, to be free from defects in material and workmanship under normal use and service, for a prorated period of two (2) years from the date of delivery to the original Purchaser
2. Activation of Warranty: To activate this Limited Warranty the original Warranty Registration form/installation checklist attached hereto must be completed by the Purchaser and the Licensed Electrician at the time of installation at the Purchaser, and returned to PROSUN within fifteen (15) days of installation as a condition precedent to obtaining any coverage under this Limited Warranty. Equipment intended for residential use, where a Prosun authorized dealer sells equipment to a third party, will be considered active when the equipment is installed or six months after the dealer takes possession of the equipment- whichever occurs first.
3. What is covered: During the warranty period as specified above PROSUN will replace any defective system or component, at PROSUN's sole discretion. The Purchaser shall be responsible for the difference between the cost of a new system or component and the prorated value of the defective system or component. Prior to making any repairs PROSUN will advise the Purchaser of the nature of the problem and the cost to the Purchaser based on the proration of the defective system or component.
4. What is not covered:
 - A) Starters (igniters), lamps, blue and clear filter glass.
 - B) Any failure to the external voltage transformer (example: "buck and boost" transformers)
 - C) Any damage caused by the failure of any supporting hardware not supplied by PROSUN.
 - D) Any labor charges, travel time charges, or mileage charges associated with a warranty item.
 - E) Shipping costs back to PROSUN'S factory. PROSUN will pay for ground transportation of repaired or replaced part back to purchaser.
 - F) Sunshower Tanning units, parts or components damaged in transit where PROSUN'S damaged goods policy is not followed by purchaser or purchaser's designee.

This warranty does not apply to any failure of product due to alterations, modifications, misuse, abuse, neglect, accident, improper maintenance or installation, use of parts not supplied by PROSUN, failure to operate and use the product in accordance with the instructions provided in the Owner's Manual supplied with the product or failure to otherwise meet manufacturer's specifications, or if the serial number and/or warranty voided label has been removed, altered or defaced.

6. Procedure for Requesting Warranty Work: In the event of a problem covered under this limited warranty, the customer must first contact PROSUN and obtain a Returned Goods Authorization for products to be repaired or replaced at PROSUN's discretion, provided product(s) are returned freight prepaid to PROSUN. PROSUN will perform its obligation within thirty (30) days from the date of PROSUN's receipt of the Purchaser's authorization to effect repairs and acceptance of the cost of repairs based on the prorated values of the defective systems or components. Any payment due from the Purchaser shall be payable in full prior to PROSUN's return of the repaired system or component. Any product being returned to PROSUN for repair or replacement must be adequately packaged to prevent freight damage and shipped via traceable method
7. Right to Modify: PROSUN reserves the right to make changes or improvements in its products without incurring any obligations to similarly alter products which have been previously purchased.
8. Exclusivity of Warranty: This warranty is the only warranty made by PROSUN and may only be modified or amended by a written instrument signed by a duly authorized officer of PROSUN. PROSUN's sole and exclusive liability and Purchaser's sole and exclusive remedy under this warranty shall be, at PROSUN's option, to repair or replace, to the extent available on a prorated basis, any such defective Products. These remedies are available only if PROSUN's examination of such Products discloses to PROSUN's satisfaction that such defects actually exist and were not caused by Purchaser's misuse, abuse, neglect, improper installation, maintenance or testing, alterations or modifications, failure to meet manufacturer's specifications or any other cause beyond the range of normal usage, or by accident, fire or other hazard. Repair or replacement of a part does not extend the warranty period or extend the prorated value of a part or product beyond the initial two year limited warranty period from the date of delivery.

THE WARRANTY SET FORTH ABOVE IS IN LIEU OF ALL OTHER WARRANTIES, EXPRESS OR IMPLIED, INCLUDING BUT NOT LIMITED TO ANY IMPLIED WARRANTY OF MERCHANTABILITY OR FITNESS FOR A PARTICULAR PURPOSE. IN NO EVENT SHALL PROSUN BE LIABLE FOR ANY INCIDENTAL OR CONSEQUENTIAL DAMAGES WITH RESPECT TO THE PRODUCTS DELIVERED HEREUNDER OR SUBSEQUENT USE THEREOF.

9. Limitation of Liability: PROSUN shall not be liable for any loss, damages, or penalty resulting from failure to perform any of its obligations under this Agreement due to force majeure or any cause beyond its reasonable control.

PROSUN'S LIABILITY UNDER OR FOR BREACH OF THIS AGREEMENT SHALL NOT EXCEED THE REFUND OF THE PURCHASE PRICE LESS REASONABLE RENTAL FOR PAST USE. IN NO EVENT SHALL PROSUN BE LIABLE FOR COSTS OF PROCUREMENT OF SUBSTITUTE GOODS BY THE PURCHASER OR FOR UNAUTHORIZED REPAIRS UNDERTAKEN BY THE PURCHASER WITHOUT PROSUN'S PREVIOUS WRITTEN APPROVAL. IN NO EVENT SHALL PROSUN BE LIABLE FOR ANY SPECIAL, CONSEQUENTIAL, OR INCIDENTAL DAMAGES, HOWEVER CAUSED, WHETHER FOR BREACH OF WARRANTY, NEGLIGENCE, OR OTHERWISE. PROSUN DISCLAIMS ANY OBLIGATION OR LIABILITY FOR LOSS OF USE OF THE PRODUCT WARRANTED, LOSS OF TIME, INCONVENIENCE, RENTAL OR SUBSTITUTE PRODUCTS, LOSS OF BUSINESS, LOSS OF INCOME, COMMERCIAL LOSS OR ANY OTHER DIRECT, CONSEQUENTIAL, SPECIAL OR INCIDENTAL DAMAGES.

10. Governing Law: Notwithstanding principles of conflicts of law of any jurisdiction to the contrary, all terms and provisions of this Agreement are to be construed and governed by the laws of the state of Florida without regard to the laws of any other jurisdiction. The Purchaser waives any and all privileges and rights which they may have under Chapter 47, Florida Statutes (1993), relating to venue as it now exists or may hereafter be amended, and under any other statute, or administrative provision thereof in any legal action on this Agreement; and further, the Purchaser agrees that any legal action brought on this Agreement or in connection therewith, shall be brought in the appropriate court in Pinellas County, Florida.
11. Attorney's Fees: Should a dispute arise with regard to this warranty or any other aspect of this sale the prevailing party shall be entitled to reasonable attorneys fees and costs through appeal.